

REV	ZONE	REVISION	DATE

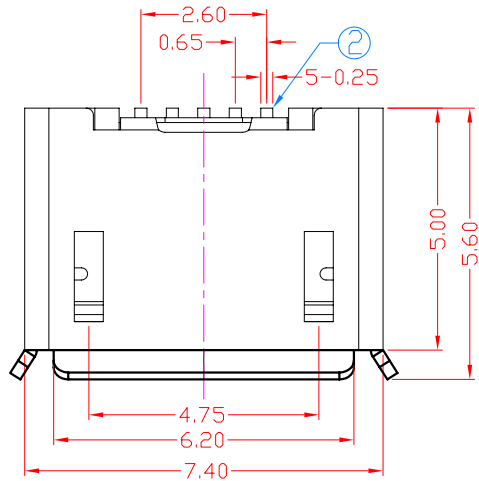

Green Product

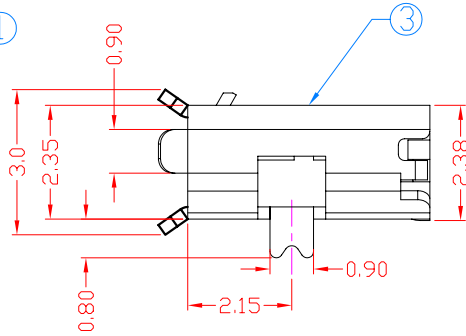
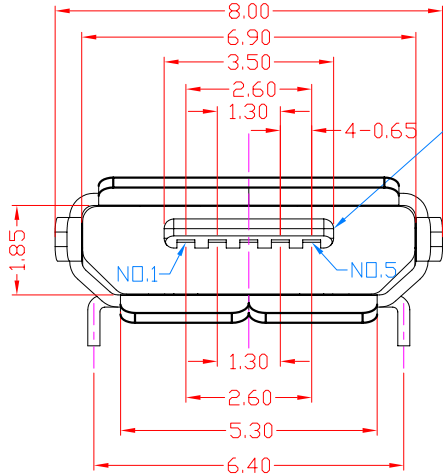
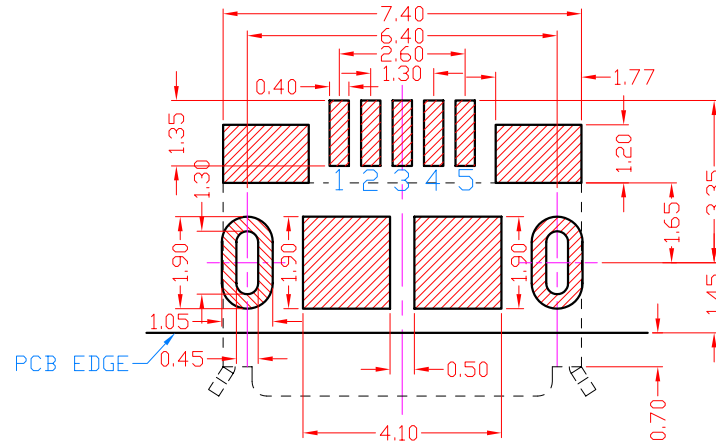

Specification:

COMPONENT SIDE
PCB LAYOUT

***Contact Resistance:**

- (1)30m Ohm Max. at 100mA
- (2)10,000 Cycles After: 40m Ohm Max.at 100mA

***Rated Voltage: AC 30V**

***Contact Current Rating:**

- (1)Signal Line: 1A/Pin (No. 1 to 5)
- (2)2-Line For Power: 1.8A/Pin(No. 1 and 5),0.5A/Pin(No. 2 to 4)

***Insulation Resistance: 100M Ohm Min. At 500V DC**

***Dielectric Withstanding Voltage: 100V AC for 1 Minute**

***Durability (Life Test): 10,000 Cycles Front**

***Insertion Force: 35 Newton Maximum**

***Extraction Force: 8 Newton Minimum.**

***Operating Temperature: -30°C to +80°C**

***Solderability: 260°C±5°C;5 Sec**

ROHS COMPLIANT

NO.	NAME	MATERIAL	FINISH	Q'TY	REMARK
1	HOUSING	LCP+GF30%	BLACK	1	
2	PIN TERM.	PHOS.BRONZE(EH) t:0.20mm	GOLD PLATED	5	Contact: Gold 30u" Other Area: Gold 1u"
3	SHELL	STAINLESS T=0.25	TIN PLATED(MATTE Sn)	1	TIN: 120~200u"



COMPUTER NO.		UNIT	SCALE	PART NAME		
		mm	1:1	MICRO USB B RECEPTACLE		
APPD.	CKD.	DWG.	DATE	TOLERANCE	PART NO.	REV.
				X. ±0.38 .X ±0.25 .XX ±0.13 .XXX ±0.05	USBS-BT8H-2.0-R	A0

MODEL

PAGE 1 OF 1

TINA

16-05-12