

DxxXSTW2NTS-R

Shell size & No positions

E09 - 9 pos

A15 - 15 pos

B25 - 15 pos

C37 - 37 pos

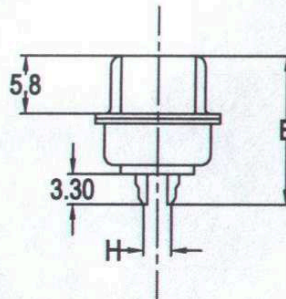
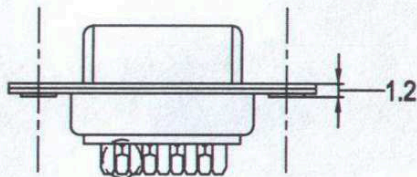
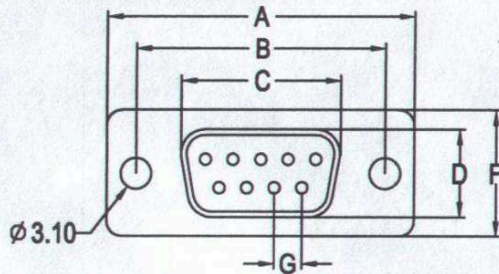

POSITION	A±0.3	B±0.2	C±0.2	D±0.2	E±0.2	F±0.2	G±0.2	H±0.1	
DS-9Pin	30.85	25.00	16.40	7.90	14.95	12.55	2.77	2.84	
DS-15Pin	39.25	33.35	24.70	7.90	14.95	12.55	2.77	2.84	
DS-19Pin	44.80	38.86	30.00	7.90	14.95	12.55	2.77	2.84	
DS-23Pin	50.30	44.30	35.30	7.90	14.95	12.55	2.77	2.84	
DS-25Pin	53.10	47.04	38.52	7.90	14.95	12.55	2.77	2.84	
DS-37Pin	69.40	63.50	54.85	7.90	14.95	12.55	2.77	2.84	
DS-50Pin	67.08	61.05	52.25	10.90	14.95	15.37	2.77	2.84	

**ELECTRICAL CHARACTERISTICS:**

CONTACT CURRENT RATING:1AMPERS.

DIELECTRIC WITHSTANDING VOLTAGE:AC 500V R.M.S

INSULATION RESISTANCE:500 MEGOHMS MINIMUM

AT DC 500V.

CONTACT RESISTANCE:30 MILLIOHMS MAXIMUM.

OPERATING TEMPERATURE:-40°C TO +70°C.

**MATERIALS:**

CONTACTS:BRASS, SELECTIVE GOLD PLATED

INSULATOR:P.B.T.UL 94V-0 RATED., WHITE

SHELL:COLD ROLLED STEEL, TIN PLATED

TOLERANCES OTHERWISE STATED

X.	±0.3
X.X	±0.2
X.XX	±0.1
X.XXX	±0.05
ANGULAR	±2°

REVISIONS		
REV	DESCRIPTION	DATE

CUSTOMER P/N:	
CH P/N.:	

TITLE: D-SUB 9pin FEMALE CONNECTOR	
DRAW BY: <i>REN</i>	CHECKED:
UNIT: mm	SCALE:

 <b>GTK UK LTD.</b>
DWG NO.: DxxXSTW2NTS-R
REV: A/0
DATE: 2002.04.18