

MATERIAL & FINISHES

- INSULATOR - P.B.T. +30%/GLASS FIBER
- UL 94V-0
- CONTACT - PHOSPHOR BRONZE
- SHELL FINISH - STEEL NICKEL PLATED
- HOOD - STEEL
- PLATING - CONTACT
 - 1. GOLD FLASH (COMPLETE)
 - 2. SELECTIVE GOLD OVER NICKEL PLATED
- <CONTACTD AREA> TIN OVER NICKEL PLATED (TAIL AREA)
- SHELL
- NICKEL OVER COPPER PLATED
- HOOD
- NICKEL OVER COPPER PLATED

ELECTRICAL CHARACTERISTICS

- RATING CURRENT : 5 AMP
 - CONTACT RESISTANCE : < 25 MILLIOHM
 - INSULATION RESISTANCE : > 1000 MEGOHM AT 500V
 - DIELECTRIC VOLTAGE : 1000V AT 1 MINUTE
 - OPERATION TEMPERATURE : -55°C TO +105°C
- APPLIED TO WAVE SOLDER CAPABLE TO 240°

ROHS COMPLIANT

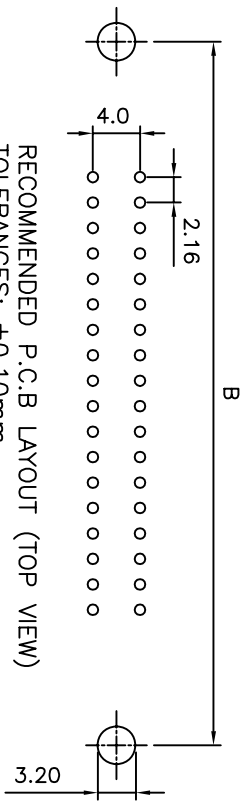
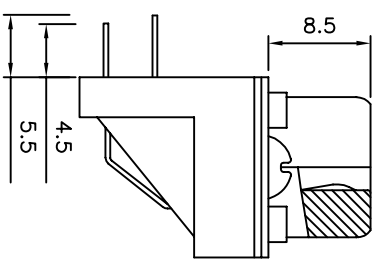
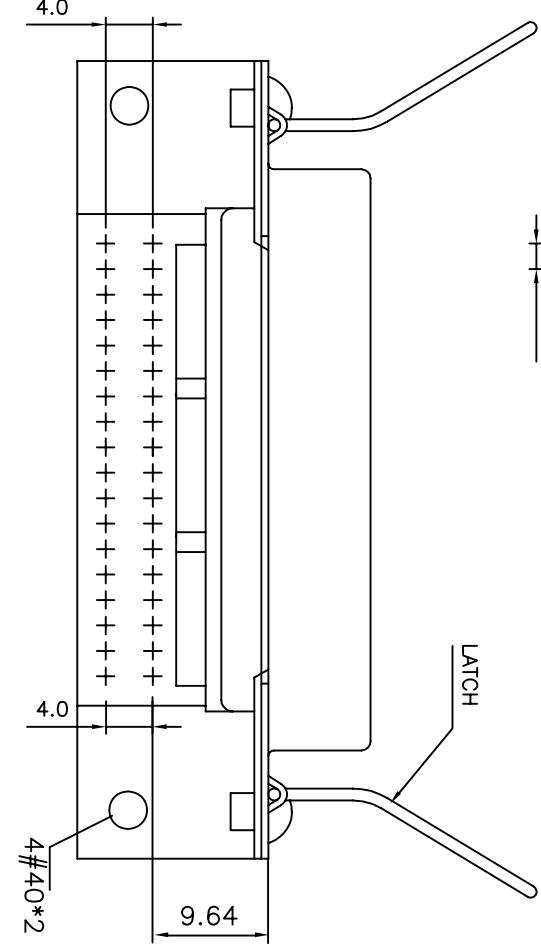
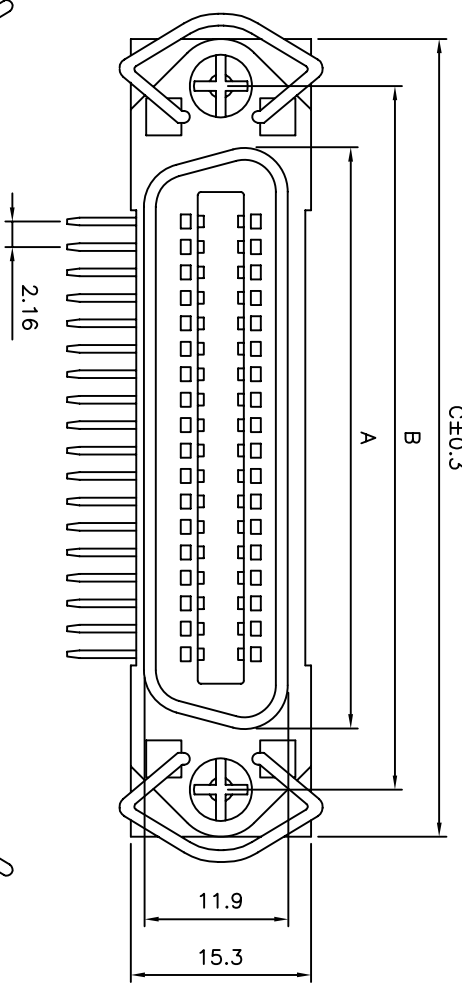

POSITION	A	B	C
14F	25.20	36.00	43.90
24F	36.00	46.80	54.70
36F	48.90	59.70	67.70
50F	64.10	74.90	82.80

UNLESS OTHERWISE SPECIFIED TOLERANCE

ANG.	0.	±0.5	±0.3	±0.2
SCALE:	AS SHOWN	UNIT:	MM	

gtr GROUP **GTK UK LTD.**

REV.	DESCRIPTION	DATE	SIZE	FILE NAME:
A	ECN-0203028(Emily)	03/07/02	A4	503A-XXFXNCABX(H2)
A		03/07/02	A	G57LFXFX-R
A				DRAWN NAME: CENTRONIC PCB RIGHT ANGLE
A				CHECKED: / / FEMALE
A				APPROVED: / /
A				DRAWN NAME: / /
A				PRODUCT NO. / /
A				1 OF 3