

# 2400 Series

## FEATURES:

- 2-20 Circuits
- .045" [1.14mm] Square wire pins or round pin
- Nylon, [UL 94V-2] or [UL 94-0]
- Straight or Right angle pins
- Mate with Center Crimp connector [2410]

## SPECIFICATIONS:

- Current rating: 7A AC, DC
- Voltage rating: 250V AC, Maximum
- Temperature range: -40°C ~ +105°C
- Contact resistance: Initial Value/10mΩ max.  
After environmental testing  
/20mΩ max.
- Insulation resistance: 5000 MΩ min
- Withstand voltage: 1500V AC/minute
- Applicable PC board thickness: .063" [1.6mm]

PIN#	DIM.A	DIM.B
02	3.96	7.92
03	7.92	11.88
04	11.88	15.84
05	15.84	19.80
06	19.80	23.76
07	23.76	27.72
08	27.72	31.68
09	31.68	35.64
10	35.64	39.60
11	39.60	4.56

PIN#	DIM.A	DIM.B
12	43.56	47.52
13	47.52	51.48
14	51.48	55.44

ROHS COMPLIANT

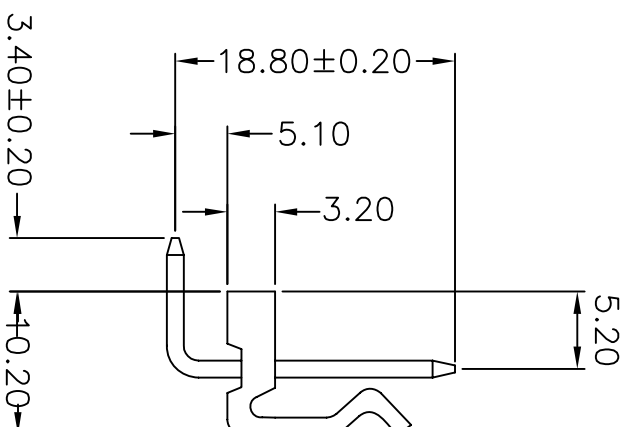
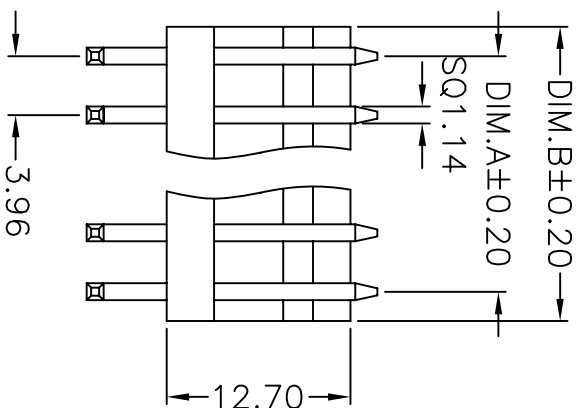

TITLE:	CUSTOMER APPROVAL	REVISION				DRAWN:		DATE	SCALE	UNIT	MM
		REV.	DESCR.	DATE	SIGN	CHECKED	APPROVED				
P/N:	2400-XX-RT-R										



**GTK UK LTD.**