

RevNo	Date	Signature	Checked
-------	------	-----------	---------

SPECIFICATIONS

ELECTRICAL CHARACTERISTICS:
 Contact Current Rating: 3 Amperes.
 Dielectric Withstanding Voltage: AC 1000/60sec.r.m.s.
 Insulation Resistance: 1000 Megohms Minimum
 Contact Resistance: 25 Milliohms Maximum.
 Operating Temperature: -55°C to +105°C.

HOW TO ORDER

DUL **XX** **-R (ROHS)**
 1 2 3 4 5

- 1. SERIES NO. DUL
- 2. CONTACT NUMBER 09 09/09
- 3. CONTACT TYPE A M/M
- 4. CENTRELINE B 8.0MM D 7.0MM
- 5. PARTS SPACING 1=22.86MM 2=19.05MM 3=15.88MM

ROHS COMPLIANT

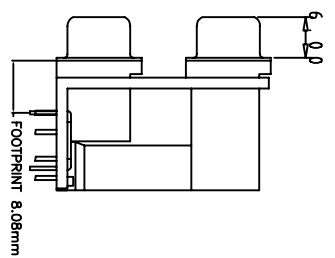
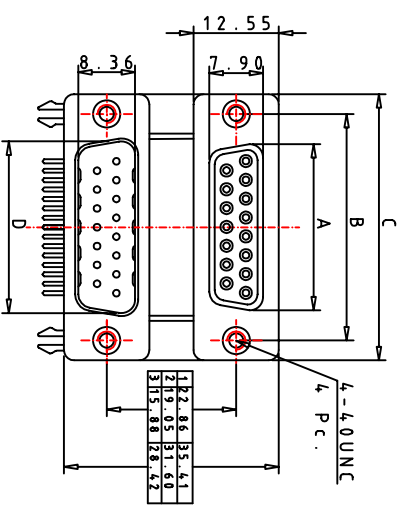

Female

No. of Contact	A ±0.25	B ±0.13	C ±0.38
09	16.53	24.99	30.81
15	24.66	33.32	39.14
25	38.58	47.04	53.04
37	54.84	63.50	69.32

Male

No. of Contact	D ±0.25	B ±0.13	C ±0.38
09	16.92	24.99	30.81
15	25.25	33.32	39.14
25	38.96	47.04	53.04
37	55.42	63.50	69.32

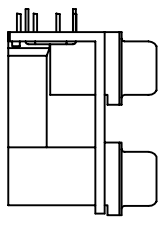
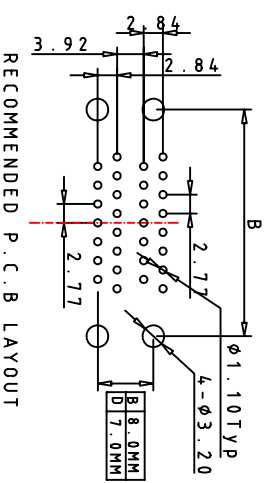
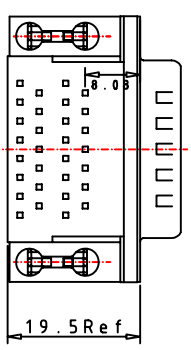

DRAW. BY: Jindafeng	DATE: 2005-10-10	UNIT: MM	TOLERANCE: UNLESS SPECIFIED	SCALE: 1:1	DWG. No.:	ANG ±?	ITEM: DUAL TWO-LINE
APPLV. BY:	VERSION: A				F: /XX/ / +		PART No. DULXXXX-R
GTK UK LTD.							CUSTOMER:

1 2 3 4 5 6 7 8